

# SONY

SSC-E450/E470 Series  
Colour Video Cameras



For surveillance where you can't afford  
to be in the dark



You make it a Sony

# SSC-E450/E470 Series



**State-of-the-art CCD technology and Digital Signal Processing (DSP) technology from Sony – Providing you with amazingly clear and detailed images for surveillance applications.**

The SSC-E453P/E458P/E473P/E478P colour video cameras are the latest additions to the Sony video surveillance camera line-up. Specifically designed for challenging lighting conditions, these cameras incorporate a newly-developed 1/3-type CCD with SuperExwave™ technology, allowing extremely high sensitivity levels to be achieved. Newly-developed Sony DSP technology allows the cameras to attain high horizontal resolution of 540 TV lines.

The CCD imager offers a minimum illumination of 0.55 lux and an excellent signal-to-noise (S/N) ratio of more than 50 dB, allowing the cameras to reproduce amazingly clear and detailed images.

What's more, the SSC-E473P/E478P models feature an automatic Day/Night function, enabling the cameras to capture high-quality colour images during the day and clear black-and-white images at night - making them perfect for 24-hour surveillance.

With excellent picture quality, a stylish new design, and a wide range of sophisticated features, the SSC-E453P/E458P/E473P/E478P colour video cameras are the ideal solutions for surveillance applications in locations such as city centres, train stations, banks, transportation facilities, schools and parking lots.



## ► Features

### Superb Picture Quality

#### State-of-the-Art SuperExwave™ CCD Technology

The SSC-E450/E470 Series incorporates a newly-developed 1/3-type CCD with SuperExwave technology that achieves extremely high sensitivity levels and produces high-quality images. This CCD imager provides a minimum illumination of 0.55 lux at F1.2, enabling the cameras to capture clear and detailed images even under low light conditions. Additionally, these cameras reproduce images with a high picture quality of 440,000 pixels and have an excellent S/N ratio of more than 50 dB.

#### Innovative DSP Technology provides 540 TVL

Unlike conventional DSPs, the newly developed DSP technology employed in these cameras increases the horizontal resolution attainable by the CCD. Due to a combination of this DSP technology and the SuperExwave CCD technology, these cameras offer a high horizontal resolution of 540 TV lines, providing amazingly clear and detailed images.

#### Day/Night Function (SSC-E473P/E478P)

The SSC-E473P and SSC-E478P feature a 'Day/Night' capability, which provides optimised sensitivity in both day- and night-shooting applications. As the scene darkens, an infrared filter is automatically replaced with a clear filter and the camera switches to black-and-white mode, allowing for operation at a minimum illumination of 0.05 lx.

### Slim and Stylish Design

These slim and lightweight colour cameras can easily be installed in places where space is limited and where installation was previously difficult for larger cameras. A stylish rear panel cover and transparent lens cap come as standard on these cameras, so the camera will not detract from the natural decor of the room in which they are installed.

### Wide Auto Tracing White (ATW) Range

ATW is a feature that automatically adjusts the camera's white balance to adapt to changing light conditions. The SSC-E450/E470 Series provides an extremely wide ATW range of 2,000 K to 10,000 K, allowing adjustment-free operation under a variety of light conditions. Users can choose from two modes: ATW Pro and ATW. ATW Pro mode is particularly suited to applications where the operator needs to see objects as they appear to the eye. This ensures that a precise colour image is always obtained.

### Turbo AGC

The SSC-E450/E470 Series cameras are equipped with an advanced Turbo AGC function. This allows the user to boost camera gain to 24 dB, enabling viewers of the image to distinguish the subject more easily - even if it is shot in low light. The AGC mode is switchable between OFF and TURBO.

### Back-Light Compensation (BLC)

Unwanted backlighting can often cause the subject matter of an image to be cast into shadow. The BLC function incorporated in these cameras automatically compensates for such conditions and makes the subject more visible.

### CCD IRIS

The CCD IRIS function allows the use of a manual iris lens instead of a more costly automatic iris lens. As the image brightness increases, the camera adjusts the exposure by automatically reducing the CCD photo sensor's exposure time (charge accumulation time). This is achieved by using the CCD electronics shutter, which has a range of 1/50 to 1/100,000 second.

### Other Convenient Features

#### DC-Servo Lens Connection Capability

The SSC-E450/E470 Series supports the widely available DC-servo lenses.

#### CS-Mount

These cameras are equipped with a CS-mount, providing compatibility with industry-standard CS-mount lenses.

#### AC 24 V/DC 12 V Operation

The SSC-E453P and SSC-E473P accept both AC 24 V and DC 12 V power sources, and will automatically switch to the appropriate mode upon receiving power.

#### Sync System

The sync system of these cameras can be switched between internal lock and AC line lock. When AC line lock is selected, the V-phase can be adjusted by  $\pm 90^\circ$ .



# System configuration

SSC-E453P  
SSC-E473P

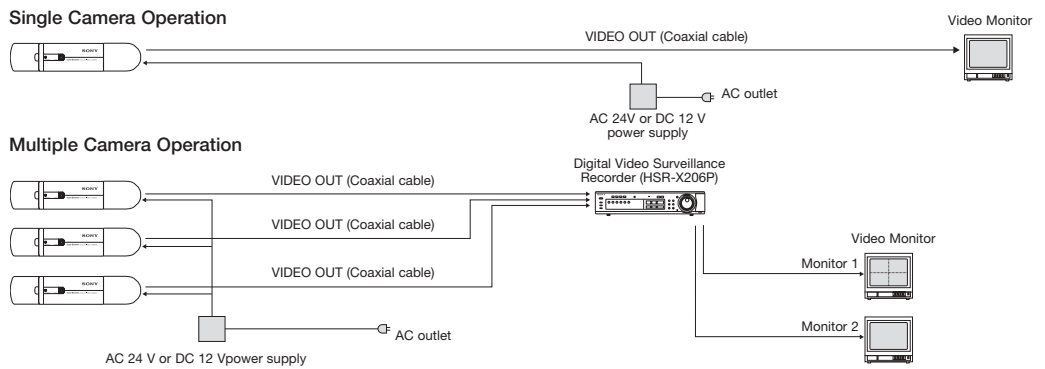

SSC-E458P  
SSC-E478P

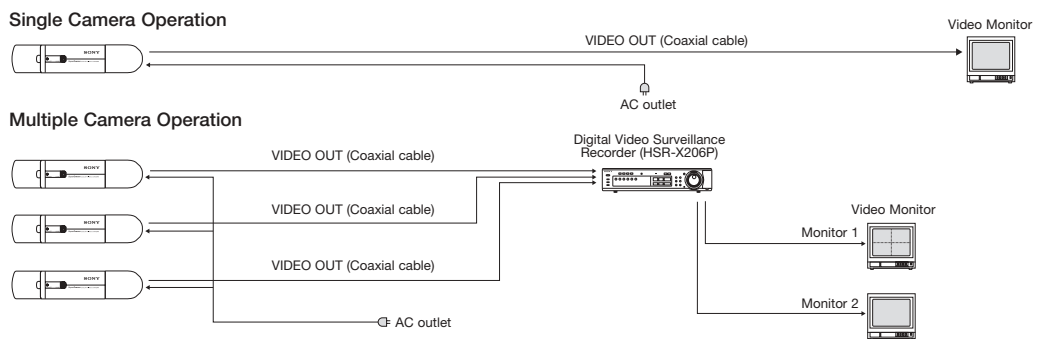

SSC-E478P

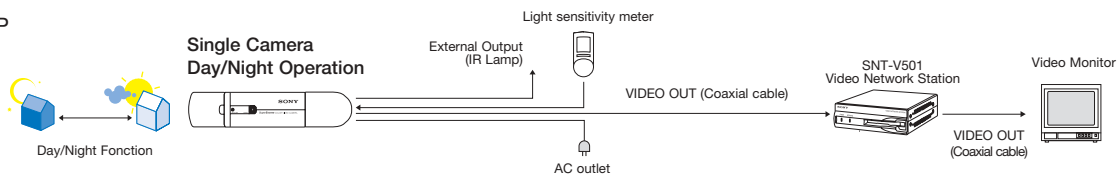

## Rear View

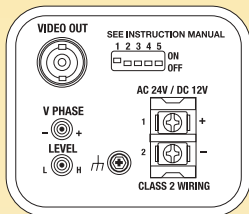

SSC-E453P

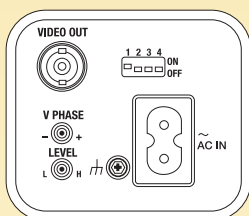

SSC-E458P

## Dimensions

SSC-E453P  
SSC-E458P

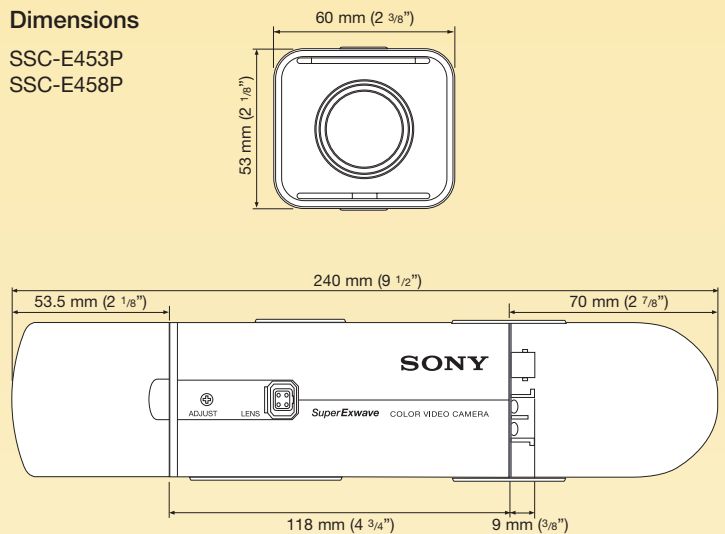

# ▶ SSC-E450/E470 Series Specifications

	SSC-E453P	SSC-E458P	SSC-E473P	SSC-E478P
Image device	1/3 type Interline Transfer CCD with SuperExwave™ HAD Technology			
Picture elements (H x V)	752 x 582			
Sensing area	1/3 type format (4.8 x 3.6 mm)			
Signal system	PAL standard			
Sync system	INT/Line Lock			
Horizontal resolution	540 TV lines			
Lens mount	CS			
Minimum illumination	0.55 lux at F1.2 (50 IRE, AGC ON, Turbo mode)		Colour: 0.55 lx at F1.2 (50 IRE, AGC ON, Turbo mode) B&W: 0.05 lx at F1.2 (50 IRE, AGC ON, Turbo mode)	
Day/Night function	-		Auto/Manual selectable	
AGC	TURBO/OFF switchable			
CCD IRIS	ON/OFF switchable, 1/50 to 1/100,000 s			
White Balance (WB)	Auto White Balance Pro [ATW Pro] /Auto White Balance [ATW]			
Backlight Compensation (BLC)	ON/OFF switchable			
S/N ratio	More than 50 dB (AGC OFF, WEIGHT ON)			
Video out	BNC, 1.0 Vp-p, 75 Ω , sync negative			
Auto iris lens	DC servo			
Operating temperature	-10 °C to 50 °C (14 °F to 122 °F)			
Storage temperature	-40 °C to 60 °C (-40 °F to 140 °F)			
Power requirements	AC 24 V ±10%, 50 Hz or DC 12 V ±10%	AC 220 V to 240 V ±10%, 50 Hz	AC 24 V ±10%, 50 Hz or DC 12 V ±10%	AC 220 V to 240 V ±10%, 50 Hz
Power consumption	3.5 W		4.0 W	
Mass	360g (12 oz)	390 g (13 oz)	380 g (13 oz)	400g (14 oz)
Mass including front & rear covers	440g (15oz)	470 g (1 lb)	460 g (1 lb 1 oz)	480g (1 lb 8 oz)
Dimensions (W x H x D)	60 x 53 x 118 mm (2 3/8 x 2 1/8 x 4 3/4 inches)		60 x 53 x 124 mm (2 3/8 x 2 1/8 x 5 inches)	
Dimensions including front and rear covers	60 x 53 x 240 mm (2 3/8 x 2 1/8 x 9 1/2 inches)		60 x 53 x 246 mm (2 3/8 x 2 1/8 x 9 3/4 inches)	
Supplied accessories	Lens mount cap (1), Operating instructions (1), Front cover(1), Rear cover(1), Screws(2), Lens mount cap (1), Operating instructions (1), Front cover (1), Rear cover (1), Screws (2), Power cable (1), (SSC-E458P & SSC-E478P)			

## Rear View

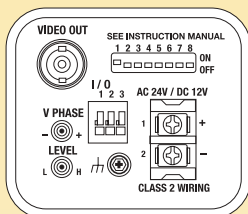

SSC-E473P

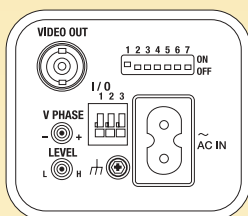

SSC-E478P

## Dimensions

SSC-E473P  
SSC-E478P

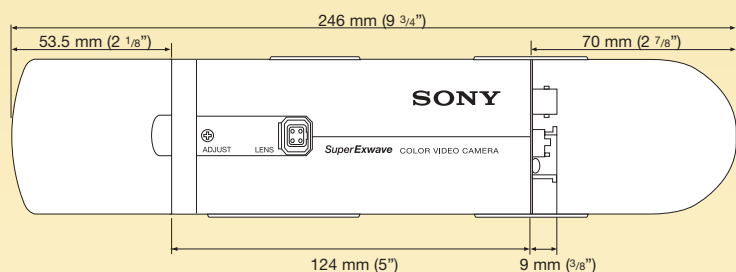
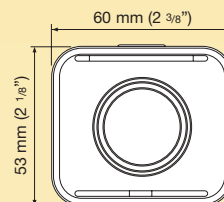

# SONY

SONY EUROPE

[www.sonybiz.net](http://www.sonybiz.net)

